



education

**Lefapha la Thuto la Bokone Bophirima
Noordwes Departement van Onderwys
North West Department of Education
NORTH WEST PROVINCE**

NATIONAL SENIOR CERTIFICATE

GRADE 12

**MATHEMATICAL LITERACY P2
ADDENDUM
SEPTEMBER 2021**

This addendum consists of 4 pages with 3 annexures.

ANNEXURE A

QUESTION 1.1

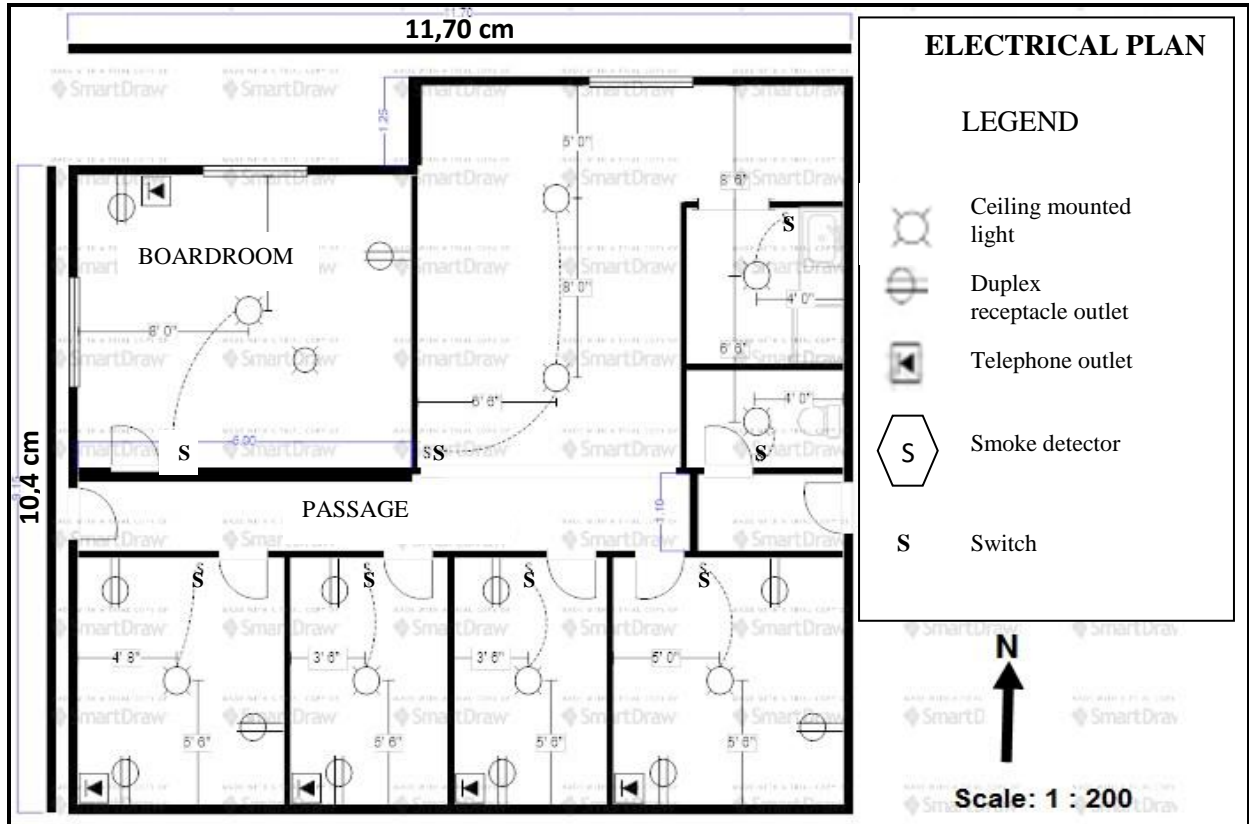

ANNEXURE B

QUESTION 2.1

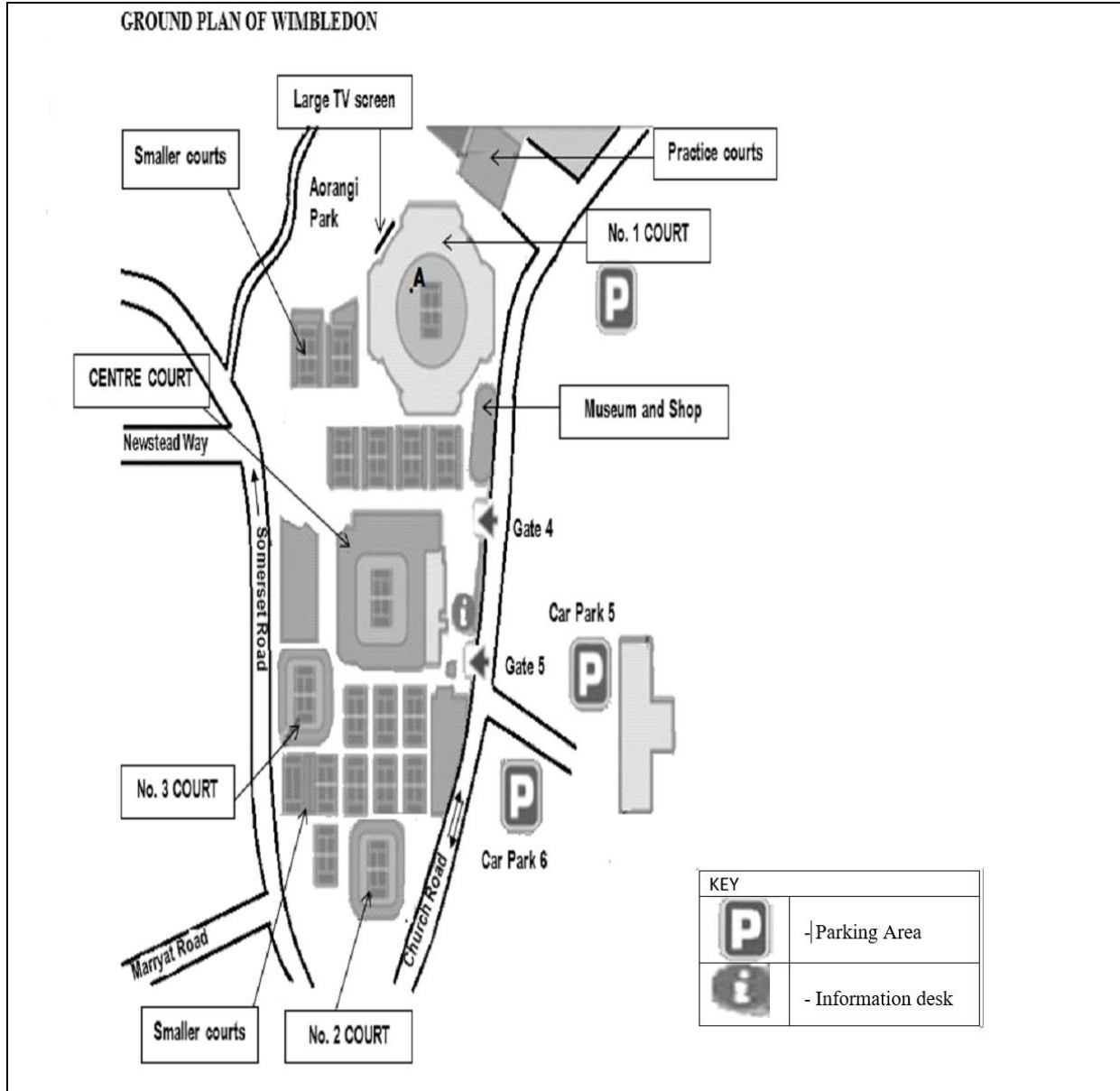

[Source: www.wimbledon.com/en_GB/atoz/faq and facts and figures]

ANNEXURE C

QUESTION 4.3

MONDAY – FRIDAY FROM DURBAN NORTH - UMHLANGA ROCKS					
ROUTE NO.	TIME	TO	ROUTE NO.	TIME	TO
716	07:15	City	716	15:00	Market
716	08:00	Market	716	16:10	Market
716	08:20	City	701	16:30	Market
716	08:30	Market	716	17:10	Market
716	09:00	Market	716	18:10	Market
716	10:00	Market	716	19:10	Market
716	13:00	Market			

MONDAY – FRIDAY FROM DURBAN NORTH - UMHLANGA ROCKS					
ROUTE NO.	TIME	FROM	ROUTE NO.	TIME	FROM
716	06:15	Market	716	08:00	Market
716	07:00	Market	716	09:00	Market
706	07:10	City	701	12:00	Market
701	07:20	City	706	16:10	City
716	07:30	Market	716	18:10	Market

SATURDAY FROM DURBAN NORTH - UMHLANGA ROCKS					
ROUTE NO.	TIME	TO	ROUTE NO.	TIME	TO
716	07:05	City-Market	716	17:15	City-Market
716	09:00	City-Market	716	19:10	City-Market
716	13:30	City-Market			

SATURDAY FROM DURBAN NORTH - UMHLANGA ROCKS					
ROUTE NO.	TIME	FROM	ROUTE NO.	TIME	FROM
716	06:10	City-Market	716	16:15	City-Market
716	08:00	City-Market	716	18:10	City-Market
716	12:30	City-Market			